

BOTTOM PERSPECTIVE

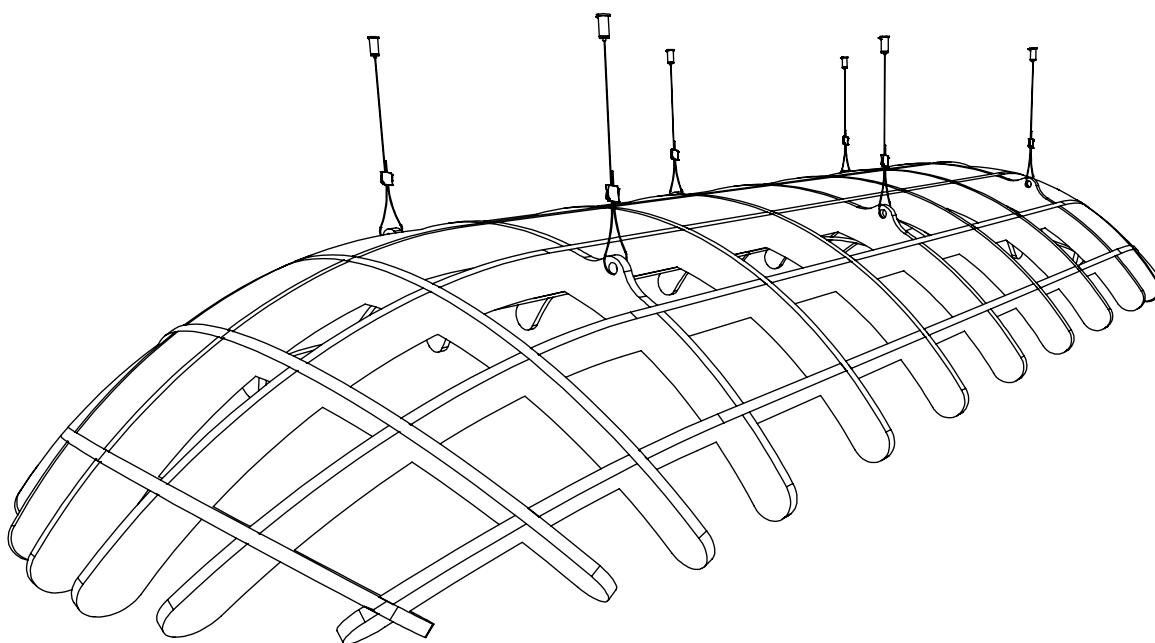

TOP PERSPECTIVE

PARTS AND HARDWARE

ZINTRA CLOUDS - CONCAVE

PARTS WILL COME FLAT PACKED WITH A TOTAL OF 14 PARTS

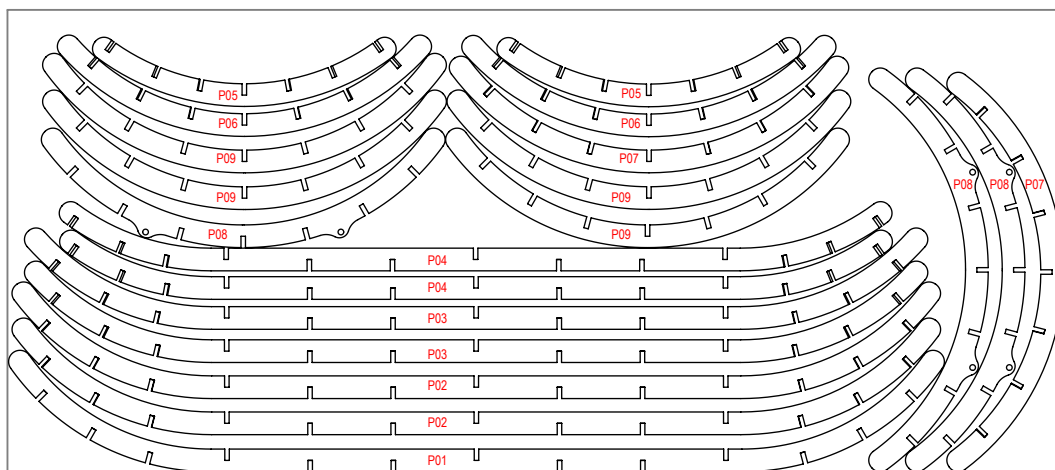

TOTAL PARTS: 20

P01: 1

P02: 2

P03: 2

P04: 2

P05: 2

P06: 2

P07: 2

P08: 3

P09: 4

(6) 1/4" - 20 HANGER BOLT (FOR USE WITH WOOD SUBSTRATE ONLY)



(6) ADJUSTABLE FASTENER



(6) CABLE WITH SWAGE END, AND BARREL



YOU WILL NEED

SPIRIT LEVEL

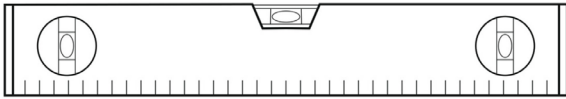

DROP SAW WITH SUITABLE BLADE FOR ALUMINIUM CUTTING

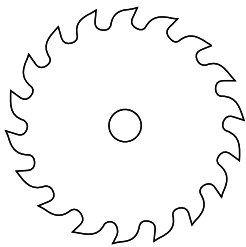

DRILL

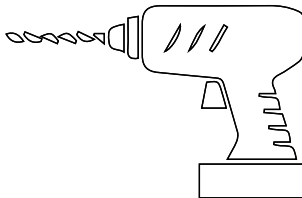

TAPE MEASURE

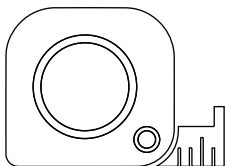

ZintraLong Dome Concave Installation Instructions

STEP 1

CHECK TO SEE IF PACKAGE CONTAINS ALL COMPONENTS. EVERY PART WILL COME WITH A NUMBER (FROM 1-8) TO REPRESENT THE CLOUD NUMBER.

THERE WILL BE A TOTAL OF 20 CLOUD PARTS:

P01: 1
P02: 2
P03: 2
P04: 2
P05: 2
P06: 2
P07: 2
P08: 3
P09: 4

AND (6) OF EACH: HANGER BOLT, ADJUSTABLE FASTENER, CABLE WITH SWAGE END AND BARREL.

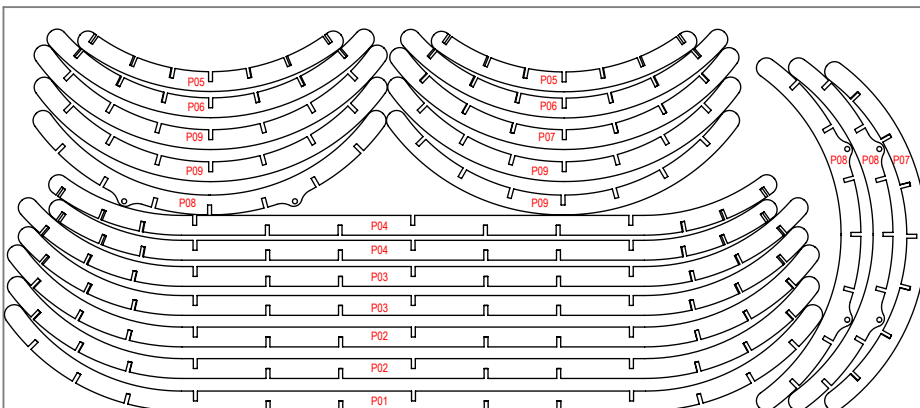

(6)



(6)

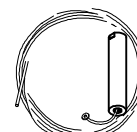

(6)

STEP 2

CONNECT P01 TO THE THREE HANGER PIECES (P08) VIA THE BOTTOM NOTCHES CIRCLED IN (A).

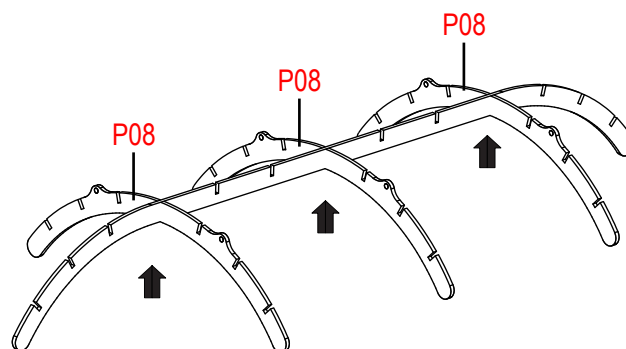
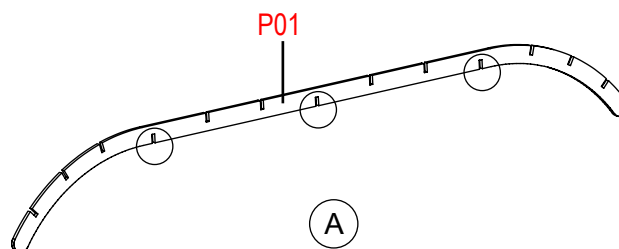

STEP 3

ADD PORTRAIT CLOUDS (LONGER) WORKING FROM THE INNER CLOUDS TO OUTER AS SHOWN FROM STEPS A TO C.

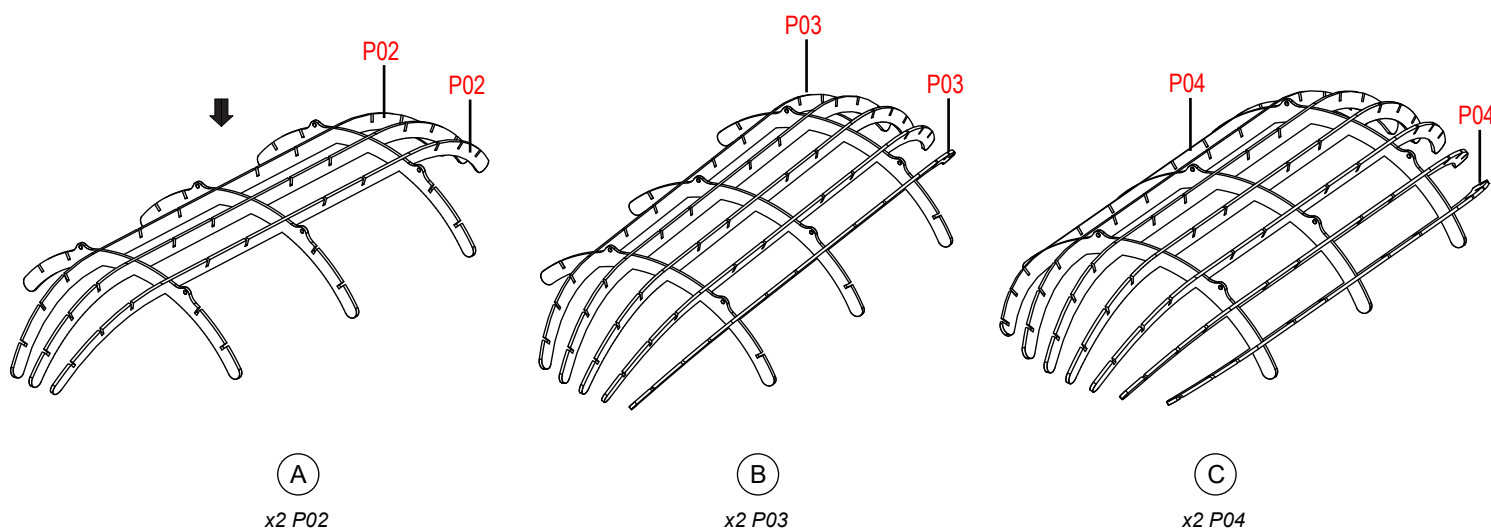

STEP 4

IMPORTANT NOTE: FOR THE FOLLOWING STEP MAKE SURE THE NOTCHES ARE FACING TOWARDS THE CENTRE. THIS IS TO ALLOW FOR THE REMANING CLOUDS TO FOLLOW THE "DOME" PROFILE.

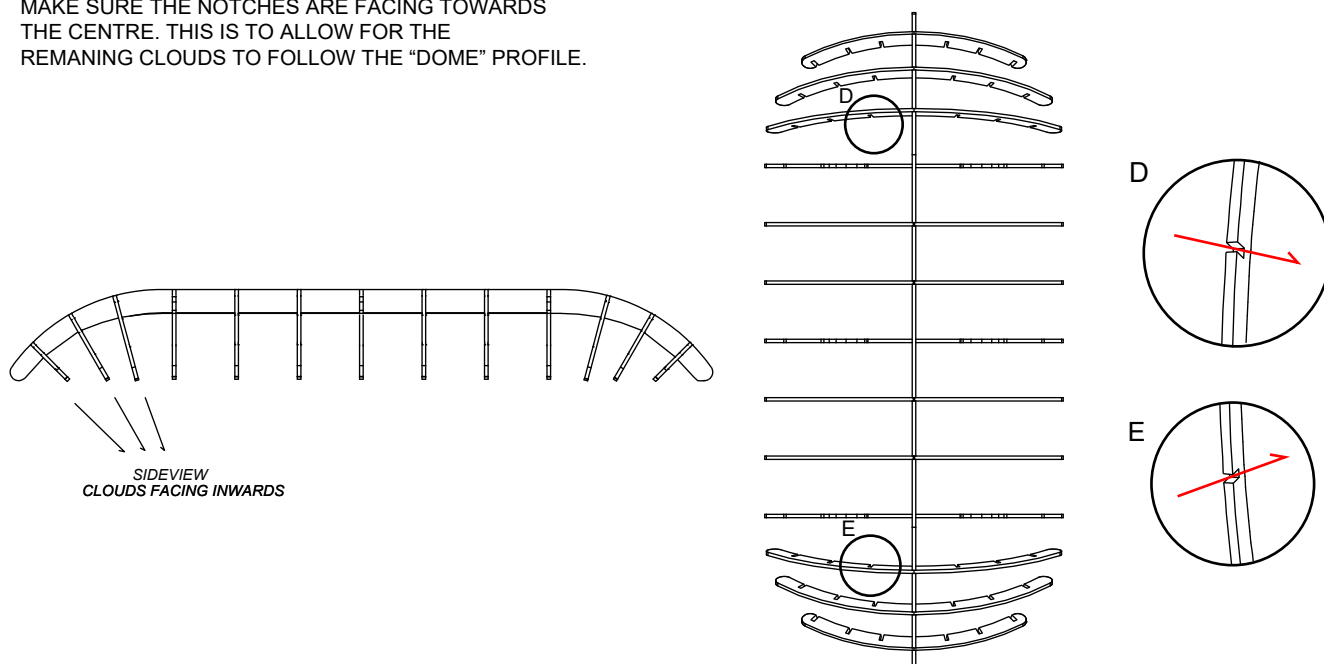

ZintraLong Dome Concave Installation Instructions

STEP 5

ADD HORIZONTAL CLOUDS (SHORTER) TO ACT AS INTERNAL RIBBING STRUCTURE WORKING FROM THE INNER CLOUDS TO OUTER AS SHOWN FROM STEPS A TO B.

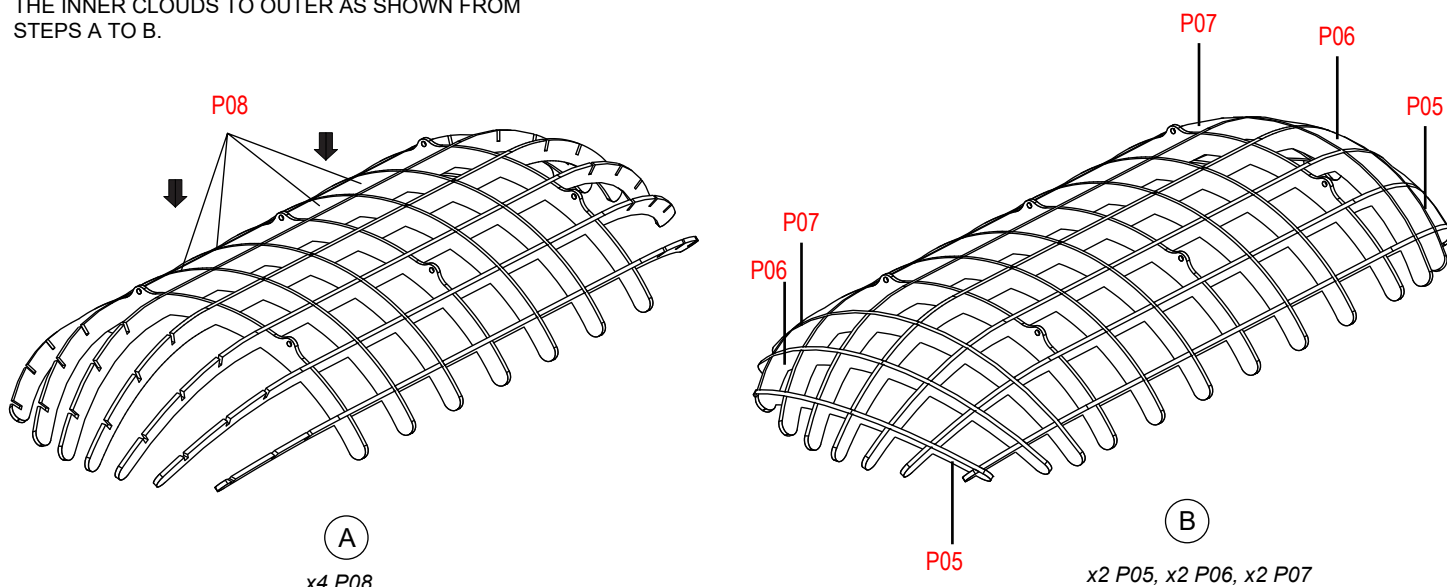

STEP 6

IMPORTANT NOTE: (SAME AS STEP 4)
MAKE SURE THE NOTCHES ARE FACING TOWARDS THE CENTRE. THIS IS TO ALLOW FOR THE REMAINING CLOUDS TO FOLLOW THE "DOME" PROFILE.

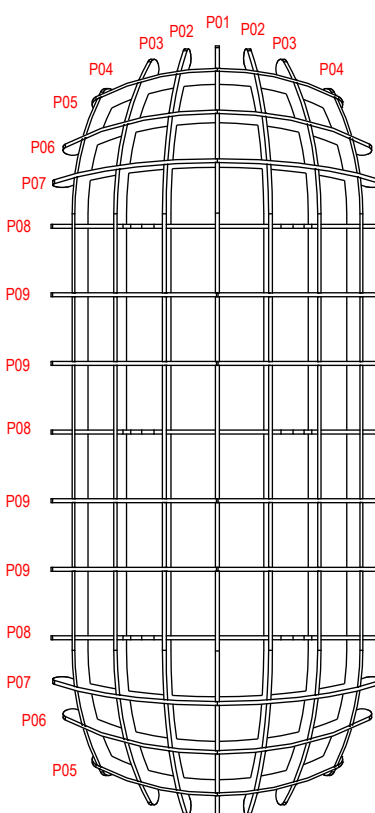
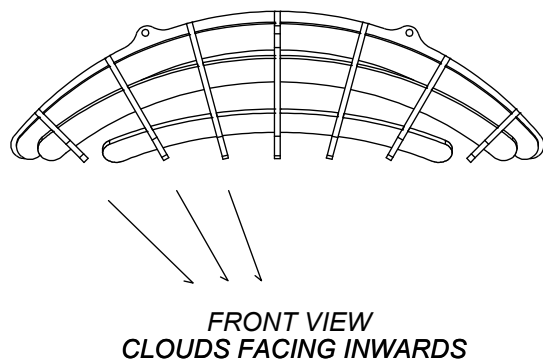

ZintraLong Dome Concave Installation Instructions

STEP 7

A. FIND THE MIDPOINT OF EACH
A.S.K (LOCATED ON P08). DIMENSION [A]

A. FIND THE MIDPOINT OF EACH
A.S.K (LOCATED ON P08). DIMENSION [B]

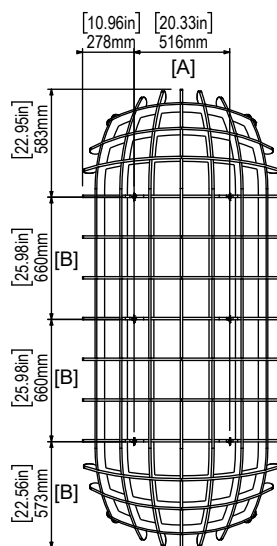

STEP 8

AFTER IDENTIFYING EACH
CORRESPONDING POINT ON THE
CEILING SUBSTRATE, TO THE POINTS
MARKED ON STEP 7, DRILL AND
ATTACH 1/4"-20 DOUBLE SIDED
HANGER BOLT TO SUBSTRATE.
REFERENCE DETAIL (SUPPLIED FOR
WOOD ANCHORING ONLY). FOR ALL
OTHER SUBSTRATES, STUDS/
ANCHORS MUST BE SOURCED BY
THE INSTALLER.

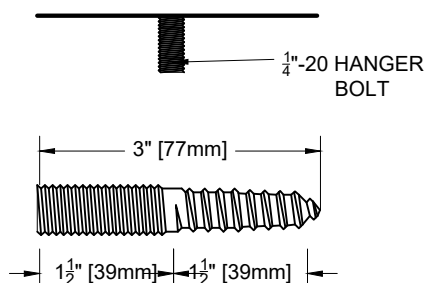

STEP 9

A. IDENTIFY THE THREADED END
OF THE BARREL AND THE SWAGE
END OF THE WIRE.

B. INSERT THE PLAIN END OF THE
SUPPLIED WIRE THROUGH THE
LARGE THREADED END OF THE
BARREL UNTIL THE SWAGE END IS
SEATED IN THE BARREL.

C. ATTACH THE THREADED END
OF THE BARREL TO 1 / 4"-20
HANGER BOLT.

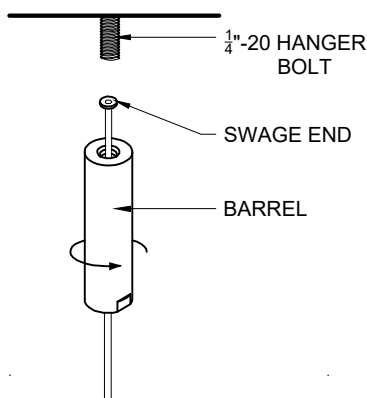

ZintraLong Dome Concave Installation Instructions

STEP 10

A. INSERT THE PLAIN END OF THE SUPPLIED WIRE THROUGH ONE SIDE OF THE ADJUSTABLE FASTENERS.

B. LOOP THE WIRE AROUND THE CROSSRUNNER WHERE MARKED.

C. RE-INSERT THE PLAIN END OF THE WIRE INTO THE REMAINING SIDE OF THE ADJUSTABLE FASTENER UNTIL SECURE.

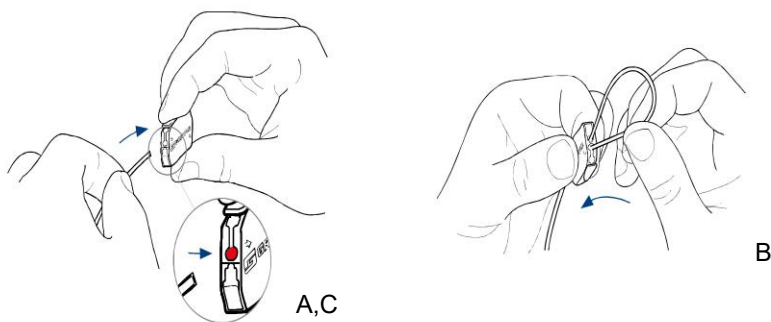

STEP 11

ONCE THE HANGING KIT IS PROPERLY SUSPENDED, TRIM THE EXCESS WIRE (IF NECESSARY) WITH WIRE CUTTERS.

NOTE: WIRE IS INFINITELY ADJUSTABLE BY DEPRESSING TAB ON APPROPRIATE SIDE.

